

# FABRIC HALL

## ASSEMBLED STRUCTURE AS-DKN12m

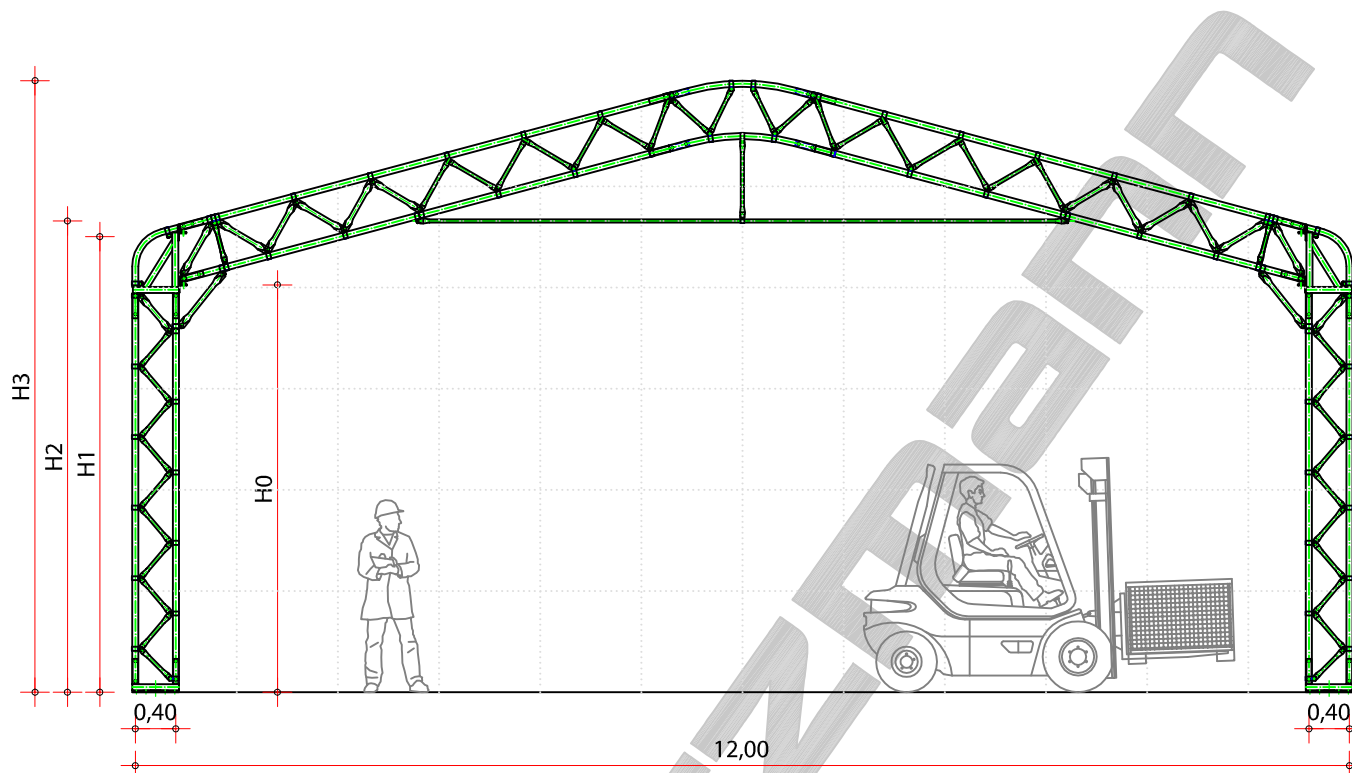

WIDTH [m]	DIMENSIONS [m]				LOADS	
	H0	H1	H2	H3	SNOW [kN/m <sup>2</sup> ]	WIND [kN/m <sup>2</sup> ]
12,00	3,00	3,50	3,65	4,95	1,00 - 1,25	0,50 - 0,70
	4,00	4,50	4,65	5,95	ACCORDING TO LOCAL REGULATIONS	
	5,00	5,50	5,65	6,95		

[www.schwarzmann.si](http://www.schwarzmann.si)  
[www.schwarzmann.eu](http://www.schwarzmann.eu)  
[www.lagerzelte-zelthallen.at](http://www.lagerzelte-zelthallen.at)  
[www.lagerzelte-zelthallen.ch](http://www.lagerzelte-zelthallen.ch)

[info@konstrukcije.si](mailto:info@konstrukcije.si)  
[info@schwarzmann.si](mailto:info@schwarzmann.si)  
[sales@schwarzmann.si](mailto:sales@schwarzmann.si)

